

of  
**Lot 1 of Certified Survey Map No. 2336.**

recorded in Vol. 11 of Certified Survey Maps of Walworth County on Page 225 as Document No. 265233 and located in the Southeast 1/4 of the Southwest 1/4 of Section 6, Town 3 North, Range 17 East, Town of LaFayette, Walworth County, Wisconsin.

Bearings referenced to the South line of Certified Survey Map No. 2336, recorded as N88°39'16"W  
A rotation of 3°29'38" from the Wisconsin State Plane Coordinate System, South Zone, (NAD-27)



45 South Wisconsin Street | P.O. Box 322  
Elkhorn, Wisconsin, 53121  
Telephone: (262) 723-3434  
Facsimile: (262) 723-8044  
Email: [doug@olsonsurveying.com](mailto:doug@olsonsurveying.com)  
Website: [www.olsonsurveying.com](http://www.olsonsurveying.com)



**Legend**

of Symbols & Abbreviations

- Found County Section Corner
- Found Iron Pipe 1-3/16" dia.
- Found Iron Rod 3/4" dia.
- Recorded Information
- Utility Pole
- Utility Pedestal
- Concrete Cover
- Asphalt Surface
- Concrete Surface
- Gravel Surface

N	North
E	East
S	South
W	West
In	Inches
Min	Minutes
Sec	Seconds
Dist	Distances
Feet	Feet
+	Intersect
N	North
NE	Northeast
E	East
SE	Southeast
S	South
SW	Southwest
W	West
NW	Northwest
N	North

Sheet 1 of 1 Sheets

Name:

Job Reference Number

2023.055

**2023.055**

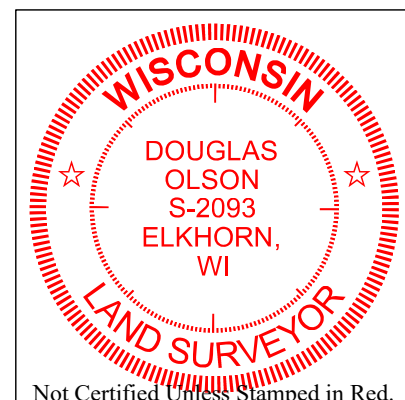

**Notes:**

- 1) This Plat of Survey is not certified unless signed and sealed in red ink.
- 2) This survey is subject to Wisconsin lien laws. This Plat of Survey is the notice of intent to file lien. Lien waiver required.
- 3) The Survey Date shown on this Plat of Survey is the completion date of the field work.

Copyright © 2023 by Olson Land Surveying, LLC.

All rights reserved. No part of this survey plat may be reproduced or transmitted in any form by any means - graphic, electronic, or mechanical, including photocopying, tracing, or information storage and retrieval systems - without permission in writing from Douglas G. Olson, Olson Land Surveying, LLC.

I hereby certify that I have surveyed the above described property in compliance with Chapter A-E 7 of the Wisconsin Administrative Code and that the map hereon is correct to the best of my professional knowledge and belief and shows the size and location of the property, its exterior boundaries, the location and dimensions of all visible structures thereon, boundary fences, apparent easements and roadways and visible encroachments, if any.

This survey is made for the exclusive use of the present owners of the property, and also those who purchase, mortgage or guarantee title thereto, within one year from the date hereof.

Douglas G. Olson  
Wisconsin Professional Land Surveyor - 2093